

## Performance

The sensitivity of the detector is determined primarily by the size, shape and composition of the object to be detected.

Typical performance figures are given below:

### Maximum Detection Range

Object	Low Sensitivity	Optimum Sensitivity
13A Power cable	8cm (3")	13cm (5")
15mm Copper pipe	13cm (5")	18cm (7")
Cavity wall tie	10cm (4")	15cm (6")
38 Calibre hand gun	20cm (8")	28cm (11")
Pen knife	10cm (4")	15cm (6")
Razor blade	5cm (2")	10cm (4")

This product emits radio frequency fields. The use of radio frequency emitting metal locators may be restricted in certain territories. Check with local authorities before use.

Operating frequency 17.0kHz +/- 1.0kHz

Max radio frequency power at 1m 64.5 dBµA/m +/- 6dB

EU declaration: C.Scope International Ltd declare that the radio equipment type CS880 is in compliance with Directive 2014/53/EU.

The full text of the EU declaration of conformity is available at [csmetaldetectors.com/doc](http://csmetaldetectors.com/doc)

# C.SCOPE

### C.Scope International Ltd.

Kingsnorth Technology Park, Wotton Road,  
Ashford, Kent TN23 6LN, UK.

Tel. +44 (0)1233 629181

Fax. +44 (0)1233 645897

email. [info@cscope.co.uk](mailto:info@cscope.co.uk)

[cscopelocators.com](http://cscopelocators.com)

C.SCOPE is an ISO 9001 Accredited Quality Manufacturer.

Waste electrical products should not be disposed of with household waste. Please recycle where facilities exist. Check with your local authority or retailer for recycling advice (In the UK visit [www.recycle-more.co.uk](http://www.recycle-more.co.uk)).

Copyright© 2019 C.Scope International Ltd.

C.Scope has a policy of continuous product development and reserves the right to change the design, specification and labelling without notice. All errors and omissions excepted.



Ref. ?????

# C.SCOPE

## Hand-Held Metal Locator

### Operating Instructions

[cscopelocators.com](http://cscopelocators.com)

# Hand-Held Metal Locator

## Operating Instructions

---

### Use

#### Building Industry

Ideally suited to locating objects hidden beneath the surface of all common building materials such as electrical wiring and pipe runs, cavity wall ties and reinforcing bars in concrete.

#### Security

Specifically designed to meet the particular requirements of personal responsible for carrying out 'hands-off' searching for concealed metal objects in suspect parcels or in clothing.

### Operation

The edge wheel has two functions, on/off tune control and sensitivity control.

1. Turn the unit on by rotating the edge wheel clockwise until it clicks on and the green LED is lit. The detector is now operational although an increase in sensitivity and depth range can be achieved by turning the edge wheel clockwise again until the red LED is lit and a constant audio tone is heard. Turn the wheel back (anti-clockwise) until the red LED just goes out and the tone fades. The detector is now tuned for optimum sensitivity and depth range.

It is recommended that the detector is set at minimum sensitivity for body searching to avoid false signals received from very small innocent metal items such as press studs or rivets.

2. Holding the unit with the detection face towards the surface, sweep backwards and forwards continuously at a height of 10 - 30mm above the area to be scanned.

The presence of metal will be indicated by the warning tone and the red light coming on.

*If the detector is held still over a metal object the detection signal will automatically reduce. It is important that the unit is continually scanning the surface when in use.*

Scan the detector over the surface at a steady rate.

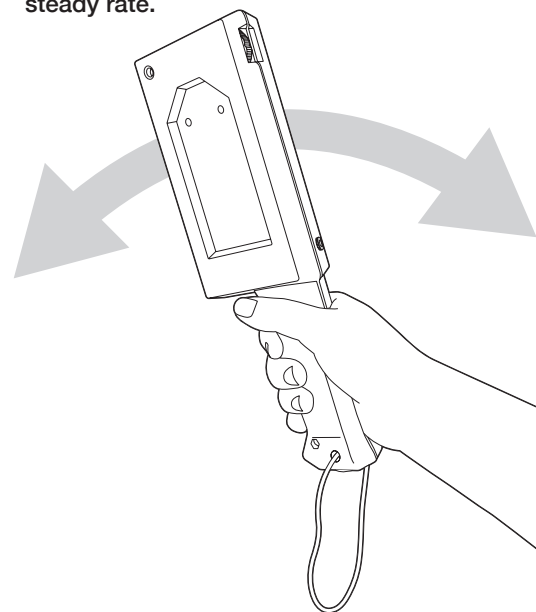

OFF position

Click down to turn ON

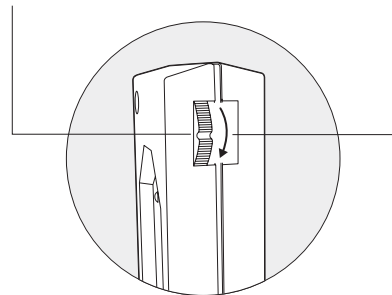

### WARNING

If the green light goes out completely or fails to come on, the unit is unstable and should not be used until the battery is replaced.

Prior to searching always test and tune the locator on a known live cable under the same conditions as those encountered in the area to be scanned.

### Notes

a. Operates on one PP3 type battery (not supplied). High power alkaline battery should be used.

Do not leave a battery in the unit if it is not to be used for a long period.

b. Mono ear-piece available as optional extra.

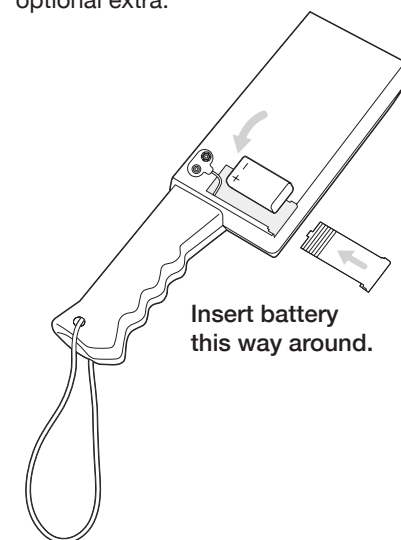

### Warranty

The C.Scope Metal Locator is guaranteed against defects in materials and workmanship for 36 months. For conditions see [cscopelocators.com/warranty](http://cscopelocators.com/warranty)